

Allatoona Lake Hunting Permit Information

The U.S. Army Corps of Engineers at Allatoona Lake Project issues, annually, four hundred hunting permits on a first-come, first-serve basis for ten specific managed areas. The permits are subject to a \$20.00 special activity fee that is assessed each season. Allatoona Lake Project Hunting Permits include permit number, name, pertinent State hunting license number, vehicle license number and a dashboard pass that needs to be displayed in vehicle while hunting. Hunting area maps and a copy of current hunting regulations may be viewed or obtained from the Allatoona website at: www.sam.usace.army.mil/Missions/CivilWorks/Recreation/AllatoonaLake/Hunting.aspx. The Special Activities Permit Fee is assessed to cover the cost to revise, print, and issue the permits and cover some costs to improve wildlife habitat around the project.

Each year, four hundred permits are issued on a first-come, first-serve basis to hunters who utilize the current 2,777 acres of public land available for this activity. These permits are not required for the Allatoona Wildlife Management Area, operated by the Georgia Department of Natural Resources.

Permits will be available on May 1st of each year, and may be obtained by submitting a request in person to the project office to include hunter name, address, telephone number, pertinent State hunting license number, vehicle license number and e-mail address. All hunters are required to have a permit in order to hunt USACE hunting areas. If multiple hunting permits are to be purchased by single request all the above information will have to be provided for each hunter. Permits will be emailed within 5-7 business days of payment or can be picked up at the Project Office.

Payment can only be made in person by card at the Project office.

Bring requests to:
Allatoona Lake Project Management Office
1138 State Route 20 Spur, SE.
Cartersville, GA 30121
Phone: (678) 721-6700

Please check out the Allatoona Lake website and Facebook page for updated information. Any questions concerning this matter can be forwarded to the Hunting Coordinator at (678) 721-6700.

ALLATOONA LAKE USACE HUNTING AREA OR REGULATION CHANGES

US Army Corps of Engineers (USACE) hunting area maps are no longer part of the permit package. Maps may be printed from the Allatoona Lake website or available at the Operations Project Management Office M– F 8am-4pm. A \$20 special activity fee is charged for USACE hunting permits this season. Permit instructions are posted on our [Facebook](#) page and on our website: www.sam.usace.army.mil/allatoona/Land%20Management/hunting.htm

=====

ALLATOONA LAKE USACE HUNTING AREA REGULATIONS

These regulations apply to all USACE-managed hunting areas at Allatoona Lake. This permit is not valid for the Allatoona Wildlife Management Area (WMA) or Durham's Pasture/Cobb County Hunting Area. Georgia laws and other Federal laws, hunting regulations, seasons and bag limits apply in addition to all USACE USC Title 36 Part 327 Rules and Regulations.

1. A valid current Allatoona USACE Hunting Permit is required to hunt USACE-managed hunting areas at Allatoona Lake. The permittee must sign and carry permit along with a current Georgia Hunting License on their person while hunting. An Allatoona USACE Hunting Permit Parking Pass must be displayed in full view on hunter vehicle dashboard while hunting.
2. All persons, regardless of age, who hunt or accompany a hunter, must acquire and possess a USACE hunting permit in their name. Hunters under 16 year old are not required to have a GA Hunting License but must be under direct supervision (as defined by GA Hunting Regulations) of a GA licensed adult.
3. Only shaded areas on maps are **open** to hunting. Unshaded areas are "**NO HUNTING**" (except Allatoona WMA & Cobb County hunting lands). All USACE Hunting Areas are "Archery Only For Deer" during deer seasons for that portion of the State.
4. Each hunter is responsible to ensure that he is within an area open for hunting. Not all of the "**NO HUNTING**" areas are posted.
5. Vehicles must be operated on existing roads. Off-road operation, driving around a barricade and operation of any non-licensed vehicle or ATV are prohibited.
6. Night hunting, trapping and target practice are prohibited.
7. Small game hunting dogs are allowed if kept within sight of the hunter and under voice control (for squirrel & bird). Trailing dogs (for rabbit, raccoon, hog & coyote) are not permitted.
8. Permanent tree stands and unattended portable stands are prohibited and subject to impoundment. Any sort of tree spikes, screws, screw steps or nails are prohibited.
9. USACE property lines are marked by red paint on trees: two stripes face the property line and three rings at corners. Any crossing of private property requires the owner's permission.

10. Waterfowl hunting may be allowed; it is not covered by this USACE Hunting Permit. See the Allatoona Website for details.

11. All USACE archery hunters, small game hunters and permittees must wear 500 sq. in. of Hunter Orange above the waist during any State firearms deer season for that section of the State. Orange is not required for spring turkey season.

12. Firearm shooting is prohibited within 600 feet of any developed area (i.e. open parks, houses, buildings, etc.).

13. **Archery Feral Hog and coyote hunting during deer season is permitted, no bag limit.**

14. Shotguns, using #4 shot or smaller, are authorized during GA seasons for small game and spring turkey, only in **Bartow Beach Road, Macedonia & Webster Overlook** Hunting Areas. Small game cannot be hunted during spring turkey season.

15. Etowah River, Kellogg Creek, South Bethany, Big Oaks, Mill Creek and Clark Creek, Vineyard Mountain Hunting Areas are only open to archery deer hunting during any State deer season for that area of state. Possession of a firearm for hunting is prohibited in these areas.

16. Vineyard Mountain Trail Area is **open Dec. 1 thru Dec. 31** for Archery only

17. Hunters may access any hunting area by boat or from any public road that crosses a USACE Hunting Area. Parking areas or common access points have been labeled on the maps. Do not block gates or park in a road.

***400 USACE Hunting Permits are available on a first-come, first-served basis until all have been issued.**

For questions call the Allatoona Lake Office at 678- 721-6700.

=====

HUNTING PERMITS MAY BE IMMEDIATELY REVOKED BY A PARK RANGER FOR ANY VIOLATION OF LAW OR REGULATION!

FREQUENTY ASKED QUESTIONS ABOUT HUNTING AT ALLATOONA LAKE

Q: What does USACE mean?

A: It is an acronym for US Army Corps of Engineers

Q: Do I need a permit to hunt deer, turkey, or small game at Allatoona Lake?

A: Yes. Everyone, regardless of age, must have an Allatoona USACE Hunting Permit to hunt deer, turkey, or small game on any USACE managed hunting areas at Allatoona Lake.

Q: Do I need a Georgia Hunting License to hunt at Allatoona Lake?

A: Yes. All State hunting regulations apply on USACE lands in addition to Federal requirements.

Q: Does my son/daughter need a permit even if they sit with me?

A: Yes. Even a small child hunting with an adult is considered a hunter. Everyone who enters the woods intending to hunt must have a permit. However, other recreationists using the areas are not required to have any sort of permit.

Q: Is there a fee for an Allatoona Hunting Permit?

A: Yes there is a Special Activity fee charged for hunting these areas for the current hunting season.

Q: When can I request a hunting permit?

A: Permit applications will be accepted starting May 1, and will be issued on a first-come, first served basis until all 400 permits have been issued. Please keep checking this website for updates on fees and procedures for getting a seasonal Hunting Permit.

Q: Do I need to complete and return a Hunter Survey after I finish hunting during the each season?

A: *Yes. Completing the survey is voluntary and will assist us in continuing and improving the hunting program for you as well as all hunters. However, completing this survey is not a requirement and we can no longer give preferential selection to hunters applying for future permits who have completed the survey.*

Q: Do I need a USACE permit to hunt Canada geese or ducks on Allatoona Lake?

A: *No. Waterfowl hunting is allowed for all hunters with a GA permit. Waterfowl hunting may be done on the water in a boat or on the dry lakebed everywhere on Allatoona Lake except within 600 feet of developed areas (structures, houses, open parks, marinas, bridges, etc.).*

Q: Do I have to record my deer on my Harvest Record?

A: *Yes. According to Georgia regulations, all deer harvested must be recorded on a hunter's Harvest Record.*

Q: Do I have to check in any game that I harvest?

A: *No. The Corps does not require hunters to check in harvested game. We do, however, appreciate the voluntary information provided in the survey issued with each Allatoona Hunting Permit.*

Q: Am I required to wear hunter orange while hunting?

A: *Yes. You must wear at least 500 square inches of hunter orange above the waist while small game or archery deer hunting in USACE areas whenever there is a hunter orange State requirement for hunters on adjacent or surrounding lands. Generally this will be during the State primitive weapons and gun deer seasons. However, other non-hunter recreationists in the areas at the same time are not required to wear orange, so please*

BE CAREFUL!!

Q: Can I hunt deer with a shotgun or rifle under the Allatoona Hunting Permit?

A: *No. Hunting deer with any sort of firearm is prohibited at Allatoona Lake except during scheduled deer hunts in the Allatoona Wildlife Management Area as managed by GADNR.*

Q: Can I hunt small game or turkeys with a gun under the Allatoona Hunting Permit?

A: *Yes, but only in Bartow Beach road, Macedonia and Webster's Overlook Hunting Areas during State seasons. Hunters may only use shotguns using number 4 shot or smaller for small game and turkeys.*

Q: Can I carry a "sidearm" to shoot snakes, varmints, etc while bow hunting deer in a USACE Hunting Area?

A: *No. Firearms are prohibited except those specifically permitted for small game and turkey and only in certain areas.*

Q: When can I hunt on Allatoona Lake?

A: *Hunters may hunt deer with legal archery equipment (according to State law) for the duration of the State set season. USACE hunters can hunt deer only with archery equipment even when surrounding or adjacent lands are open for gun deer hunting. Hunters may hunt small game and turkey with shotguns in designated USACE areas during each species' respective season according to State seasons & bag limits.*

Q: Which area is better to hunt?

A: *That depends on what you want to hunt, how you like to hunt, and how hard you're willing to work. Some places are hilly, some are flat, some are hardwood, and some are pine. The only person who can answer this question is the hunter. Most of the land around Allatoona has a variety of game and fairly healthy populations. Each hunter needs to find the area that suits him/her best by scouting them all.*

Q: Can I access the hunting property by boat?

A: *Yes. Hunters may access the Allatoona Lake hunting properties by boat if they choose to do so. Launch fees apply at public ramps unless posted otherwise.*

Q: Can I use a 4-wheeler (all-terrain vehicle-ATV) to hang stands or retrieve game?

A: *No. In accordance with Title 36 Code of Federal Regulations, The US Army Corps of Engineers does not allow ATV use on land around Allatoona Lake for any purpose. ATV's damage the forest floor and lead to erosion problems around the lake, silting in small creeks and streams and destroying valuable habitat. Hunters caught using ATVs may lose all hunting privileges at Allatoona Lake and will be cited for the offense.*

Q: Where can I find a map of the hunting areas at the Allatoona Lake Project?

A: *All USACE hunting permit area maps are on this website and can be viewed or printed by anyone. It is up to individual hunters to acquire more detailed maps or topographic maps as desired. Hunters should study maps closely and are responsible to know that they are hunting within a legal and designated area.*

Q: Where can I obtain more information on hunting laws and regulations?

A: *Georgia Department of Natural Resources – www.gohuntgeorgia.com – or contact the Allatoona Lake Project Management Office at 678-721-6700.*

ALLATOONA LAKE HUNTER SAFETY TIPS

- Never rely on your gun's safety. Treat all weapons as if they're loaded and ready to fire.
- Never cross a fence, climb a tree or stand or jump in a ditch with a loaded gun.
- Never load or carry a loaded weapon until you are ready to use it.
- Watch your muzzle so the other individuals don't have to.
- Wear hunter orange so you can be seen. A blaze orange hat and at least 400 square inches of hunter orange above the waist-line should be worn during all gun deer seasons.
- Never shoot unless you are absolutely sure of your target and what is beyond it.
- Always wear eye and ear protection when shooting firearms.

Bartow Beach Rd Hunting Area

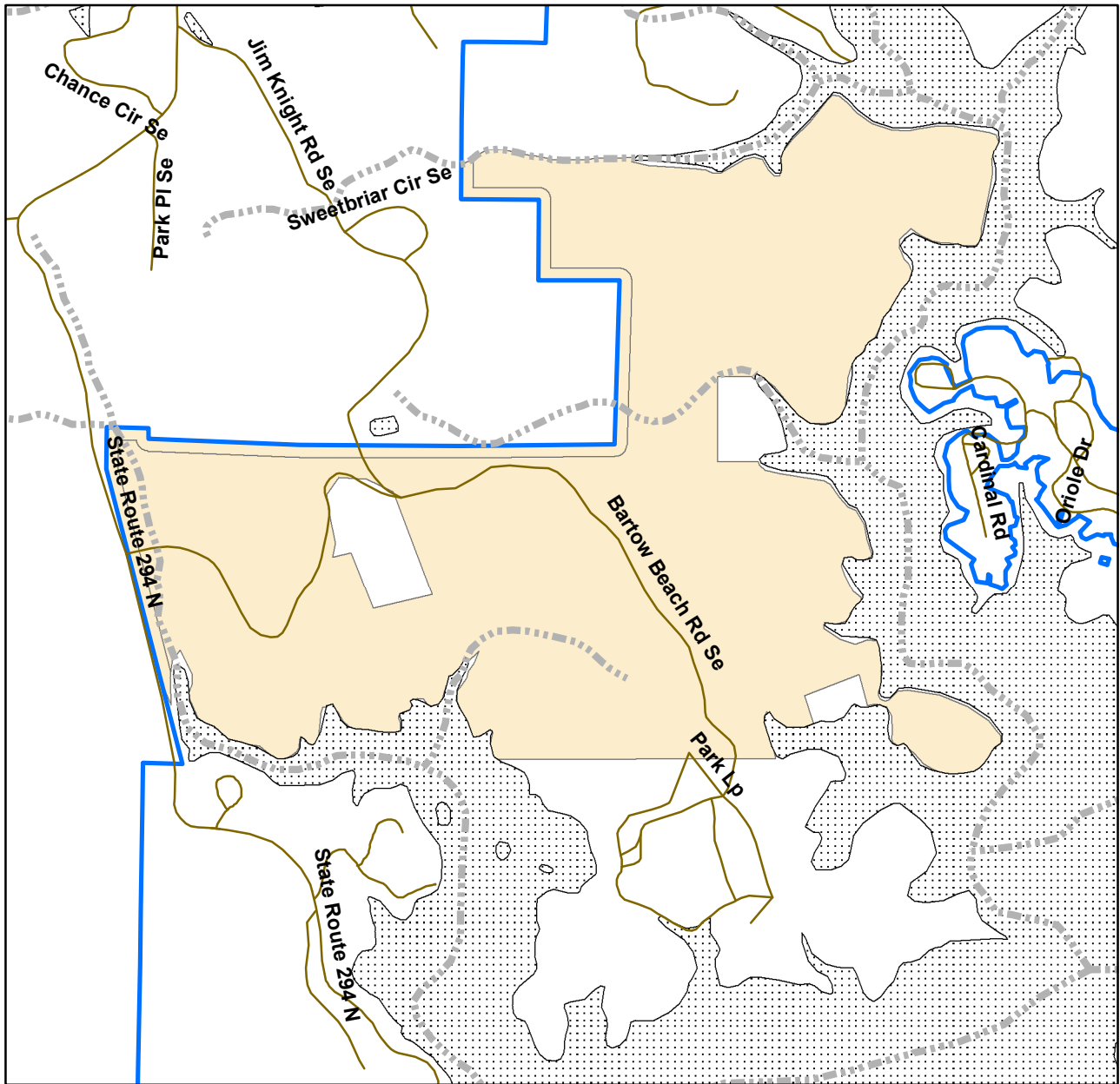

Legend

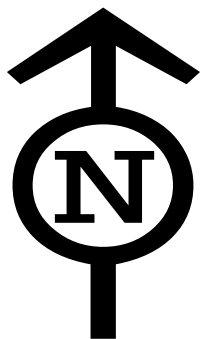

- ★ Hunting Access/Parking
- Creeks
- Major Roads
- Boundary Line
- ⋯ Lake Surface
- Hunting Area



**US Army Corps
of Engineers**
MOBILE DISTRICT

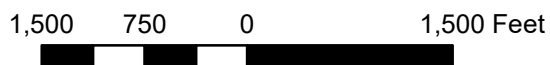

US Army Corps of Engineers
Operations Project Management Office
678-721-6700

Big Oaks Hunting Area

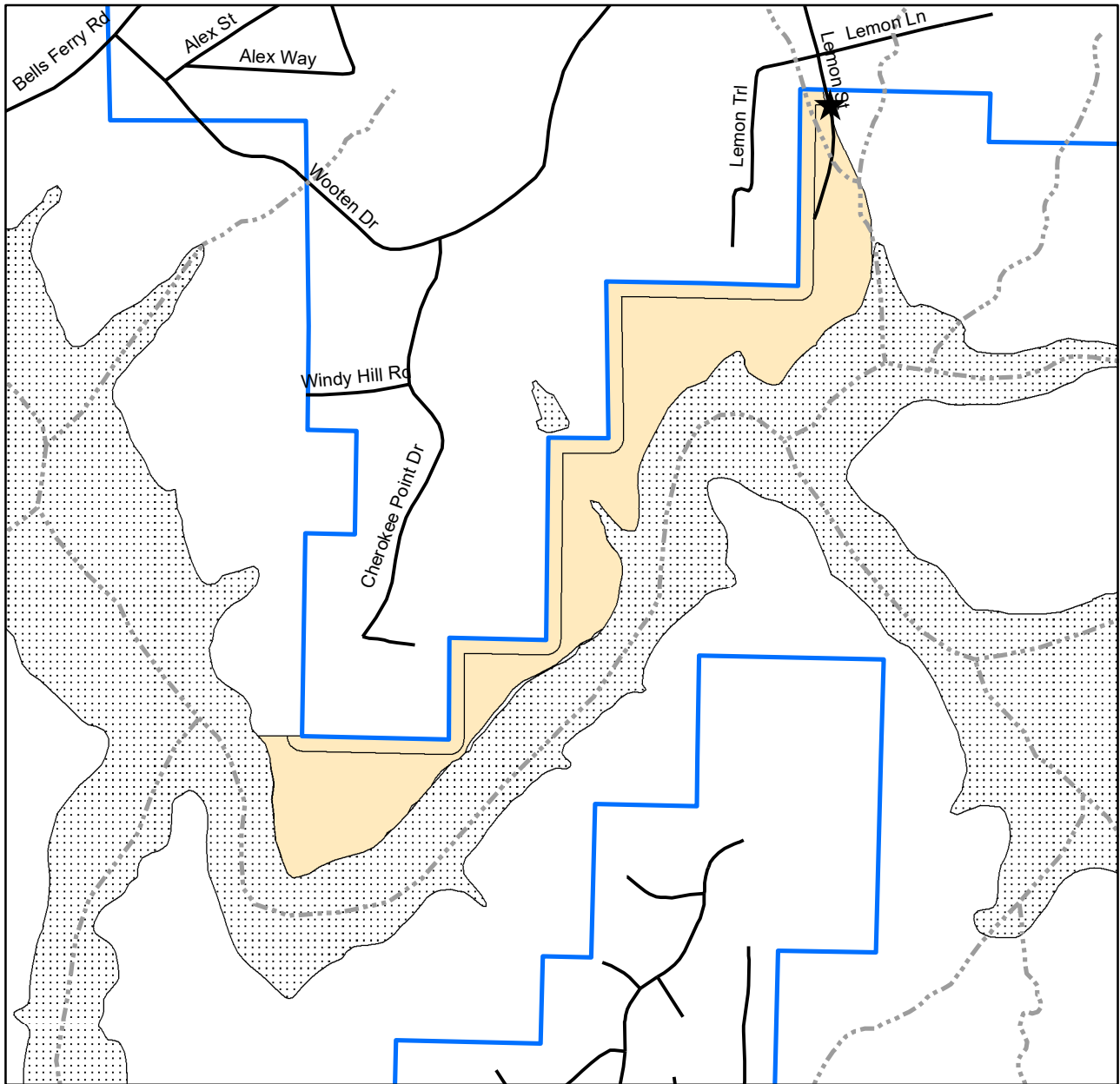

Legend

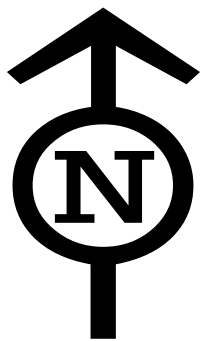

- ★ Hunting Access/Parking
- Creeks
- Major Roads
- Boundary Line
- ▨ Lake Surface
- Hunting Area



**US Army Corps
of Engineers**
MOBILE DISTRICT

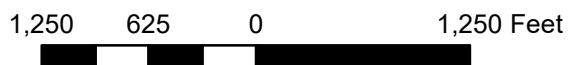

US Army Corps of Engineers
Operations Project Management Office
678-721-6700

Clark Creek Hunting Area

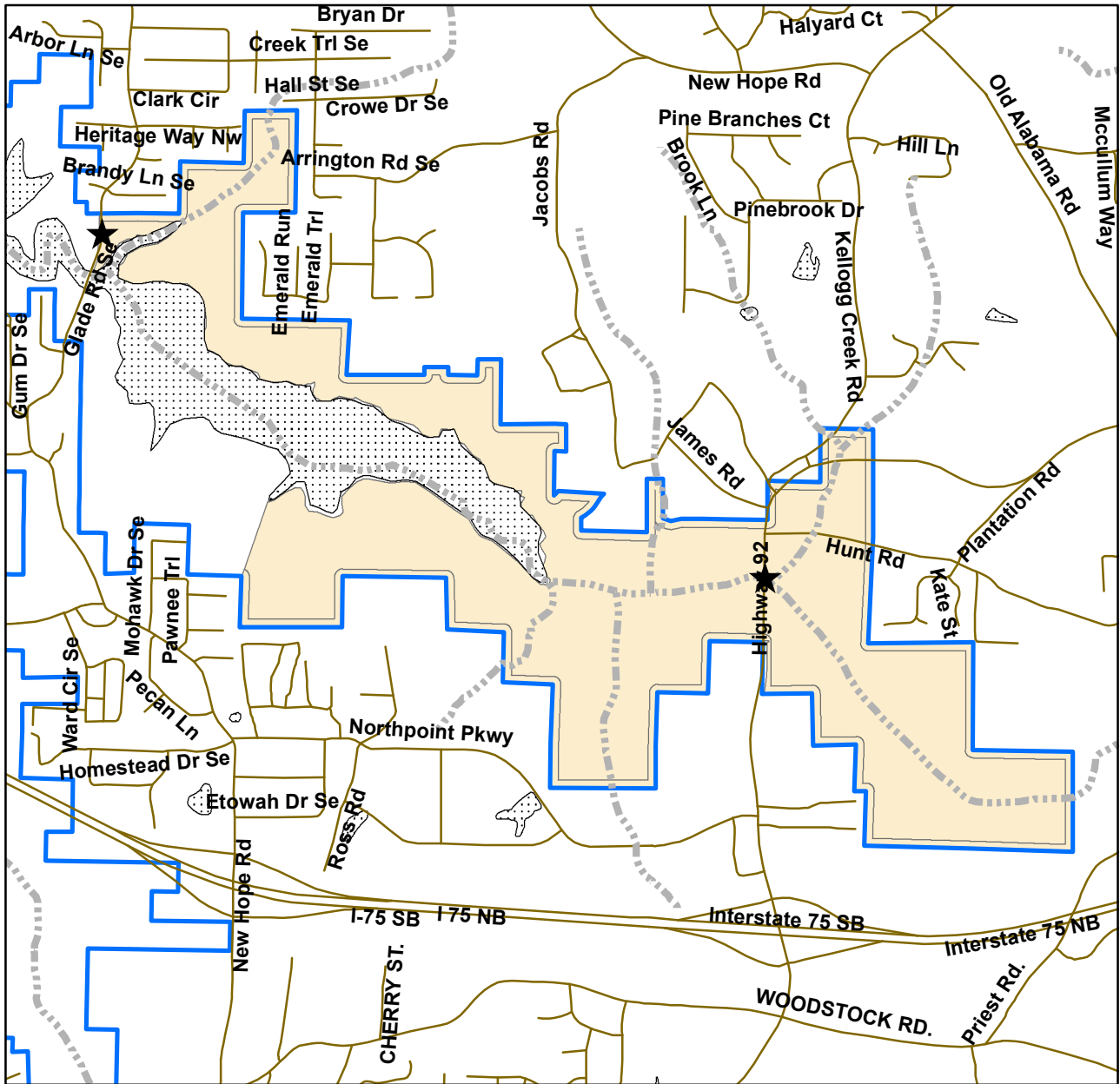

Legend

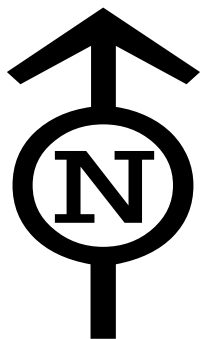

- ★ Hunting Access/Parking
- Creeks
- Major Roads
- Boundary Line
- ▨ Lake Surface
- Hunting Area



**US Army Corps
of Engineers**
MOBILE DISTRICT

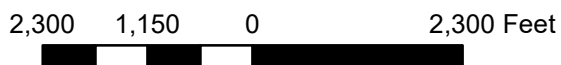

US Army Corps of Engineers
Operations Project Management Office
678-721-6700

Etowah River Hunting Area

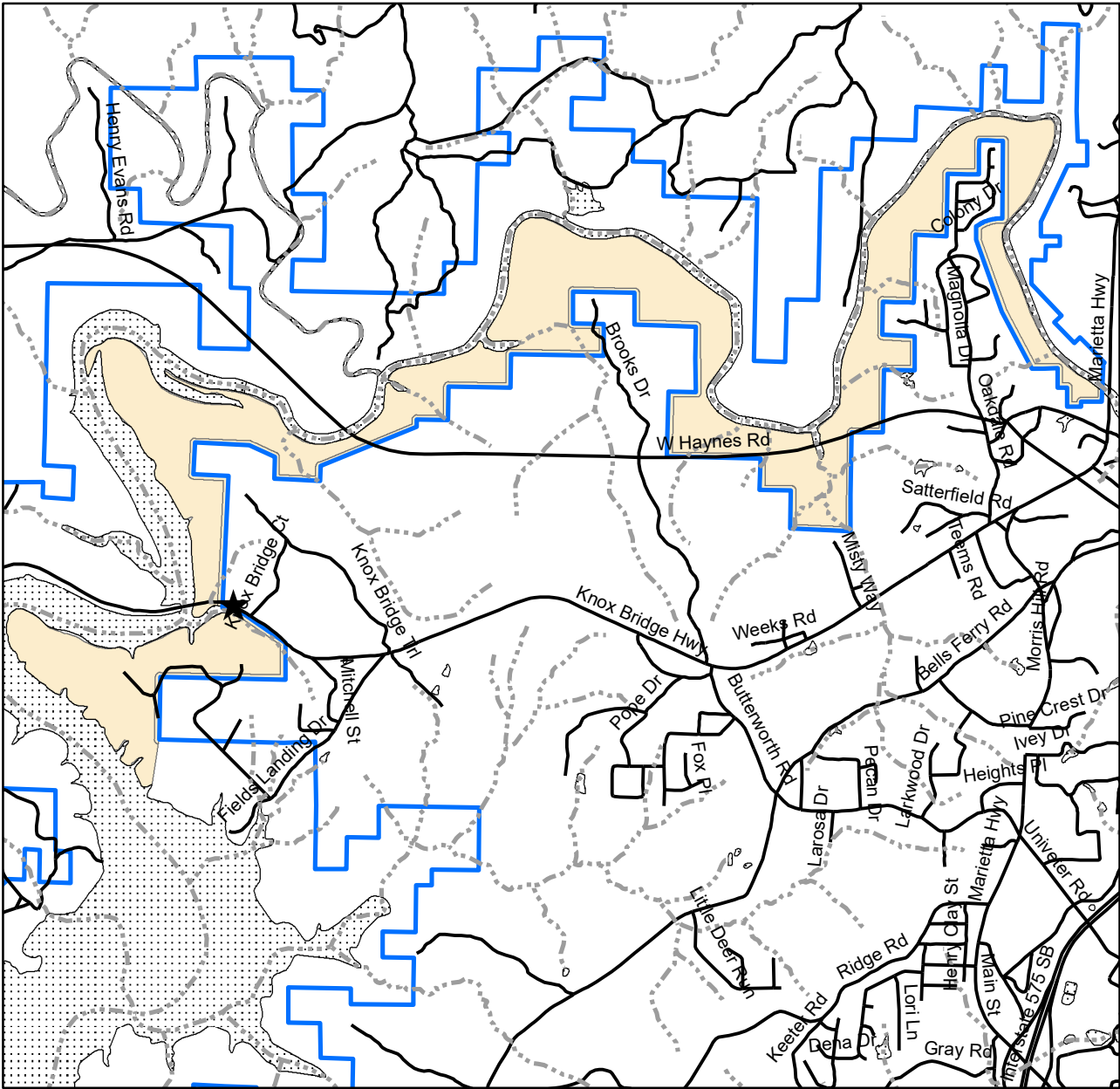

Legend

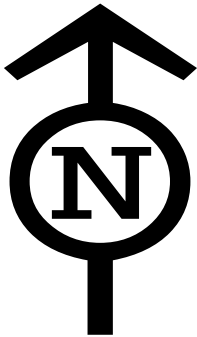

- ★ Hunting Access/Parking
- Creeks
- Major Roads
- Boundary Line
- ▤ Lake Surface
- Hunting Area



**US Army Corps
of Engineers**
MOBILE DISTRICT

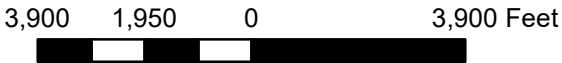

US Army Corps of Engineers
Operations Project Management Office
678-721-6700

Kellogg Creek Hunting Area

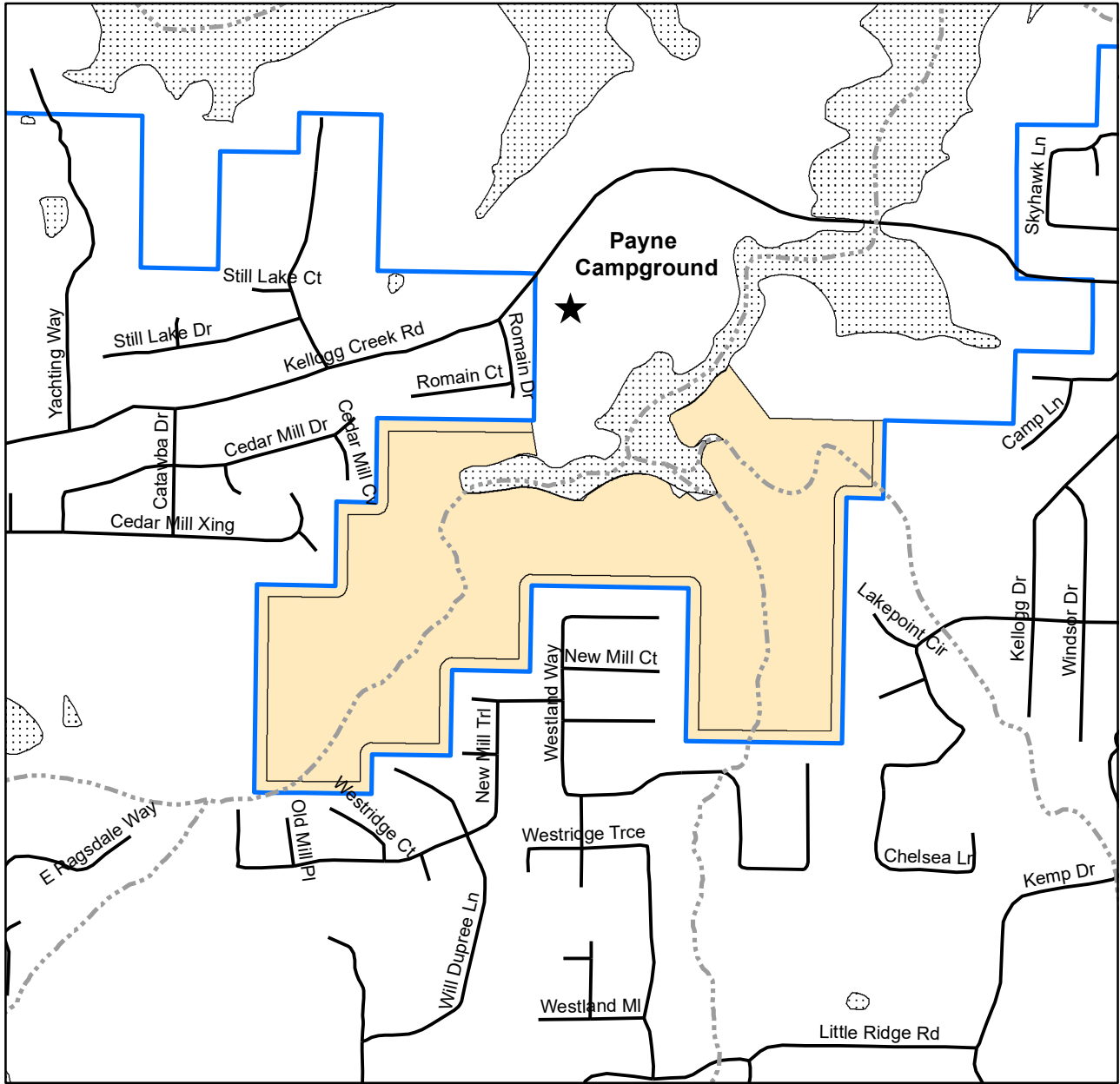

Legend

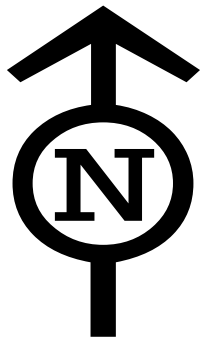

- ★ Hunting Access/Parking
- - - Creeks
- Major Roads
- Boundary Line
- ▒ Lake Surface
- Hunting Area



**US Army Corps
of Engineers**
MOBILE DISTRICT

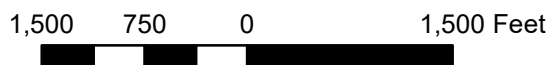

US Army Corps of Engineers
Operations Project Management Office
678-721-6700

Macedonia Hunting Area

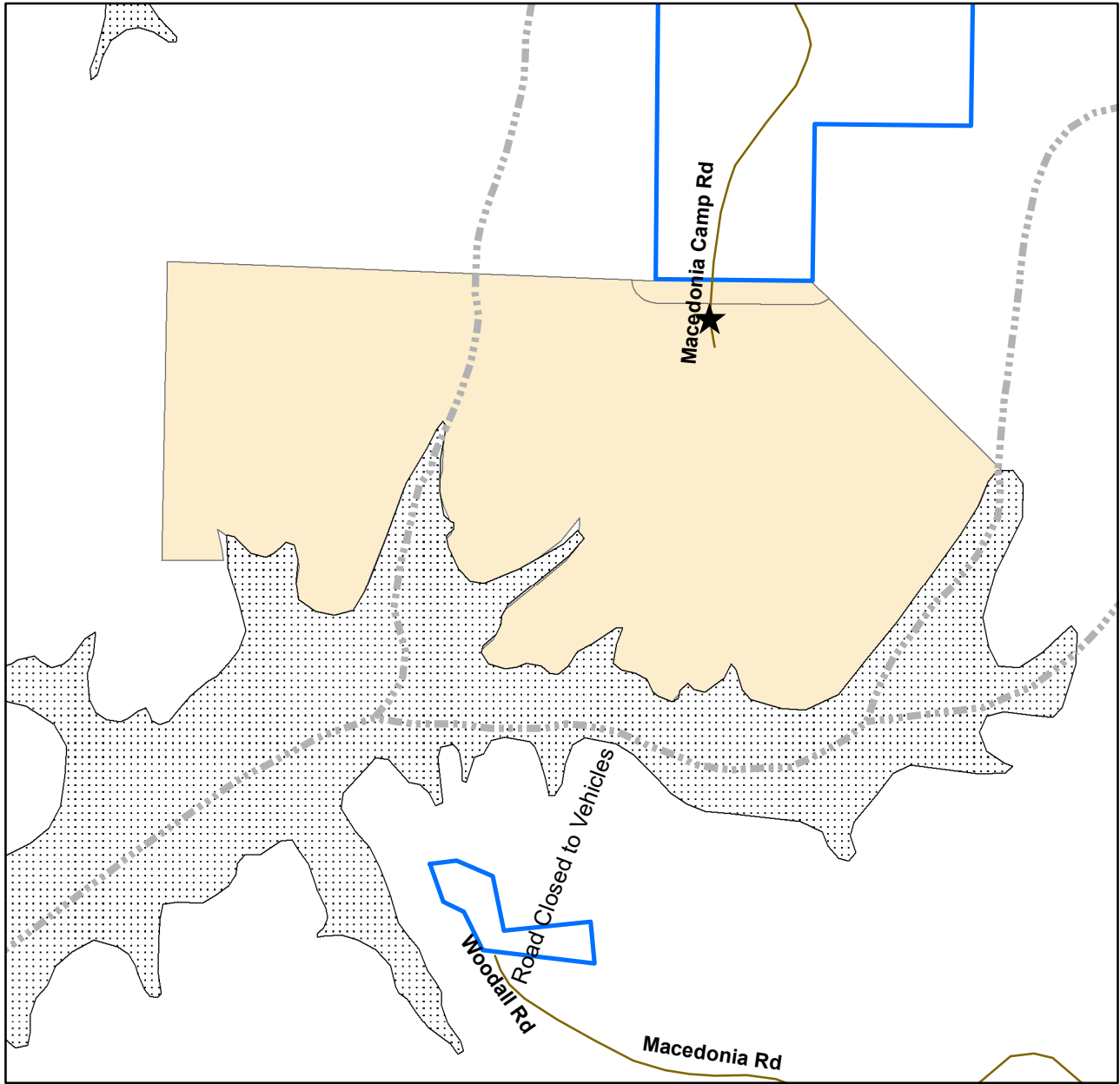

Legend

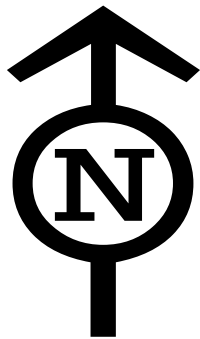

- ★ Hunting Access/Parking
- Creeks
- Major Roads
- Boundary Line
- ▨ Lake Surface
- Hunting Area



**US Army Corps
of Engineers**
MOBILE DISTRICT

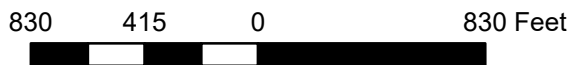

US Army Corps of Engineers
Operations Project Management Office
678-721-6700

Mill Creek Hunting Area

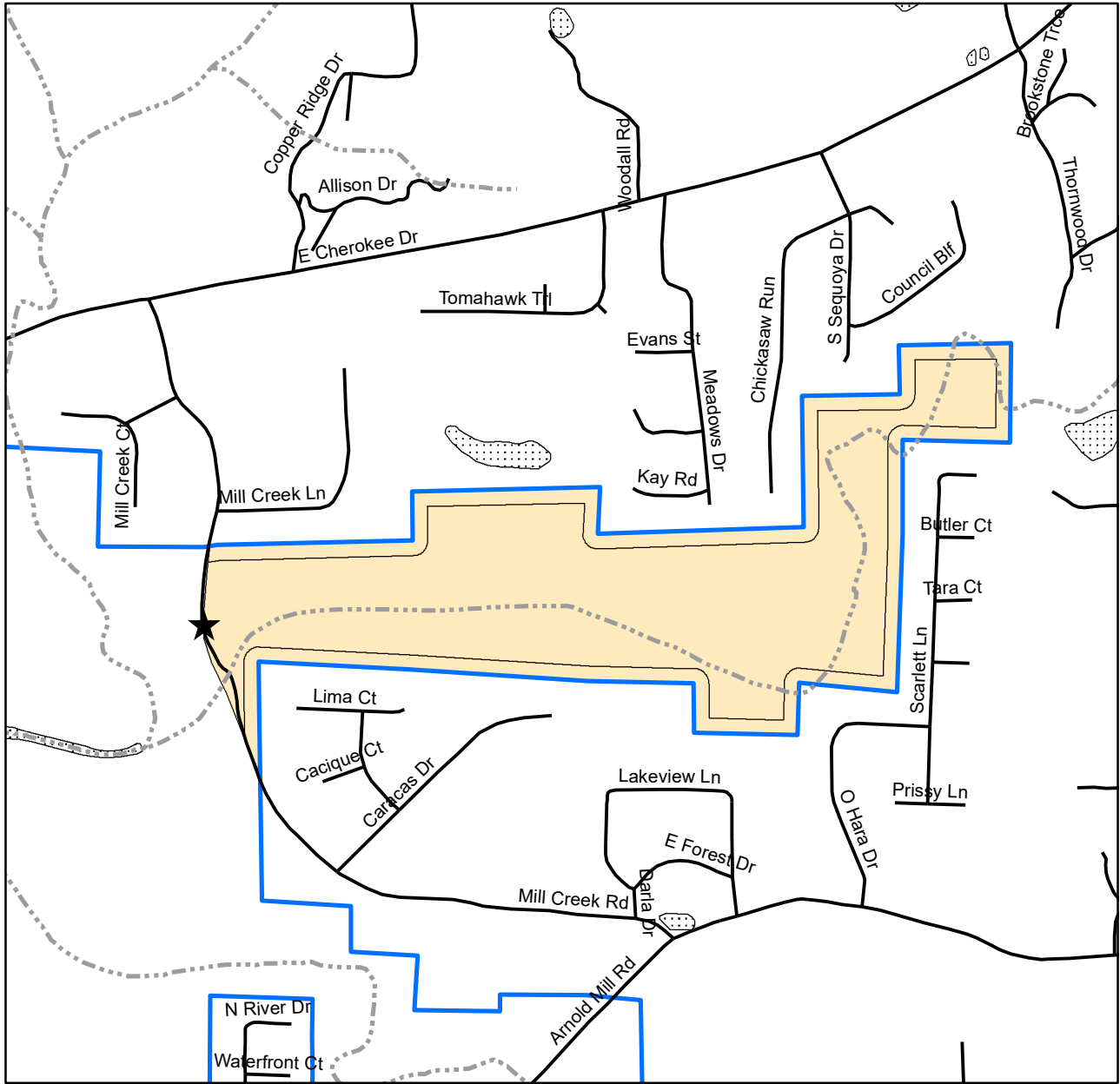

Legend

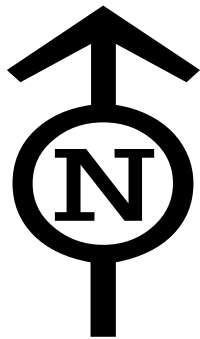

- ★ Hunting Access/Parking
- - - Creeks
- Major Roads
- Boundary Line
- ▤ Lake Surface
- Hunting Area



**US Army Corps
of Engineers**
MOBILE DISTRICT

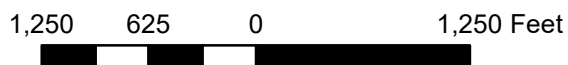

US Army Corps of Engineers
Operations Project Management Office
678-721-6700

South Bethany Hunting Area

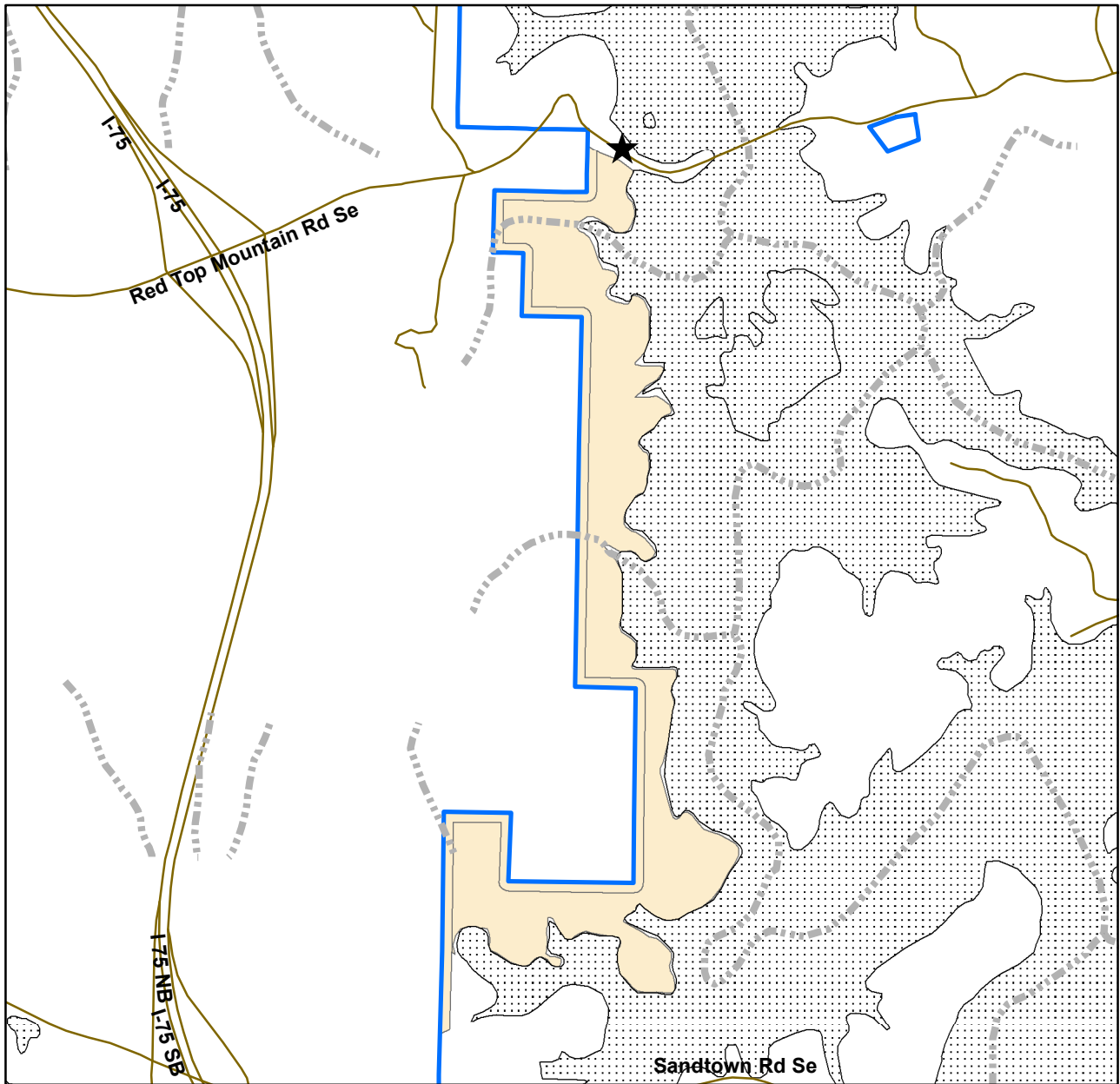

Legend

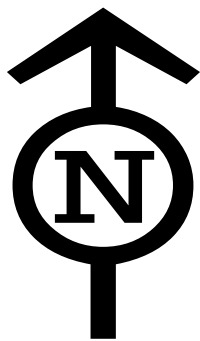

- ★ Hunting Access/Parking
- Creeks
- Major Roads
- Boundary Line
- ▨ Lake Surface
- Hunting Area



**US Army Corps
of Engineers**
MOBILE DISTRICT

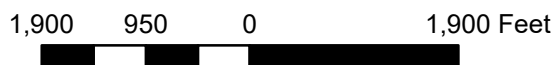

US Army Corps of Engineers
Operations Project Management Office
678-721-6700

Vineyard Mountain Hunting Area

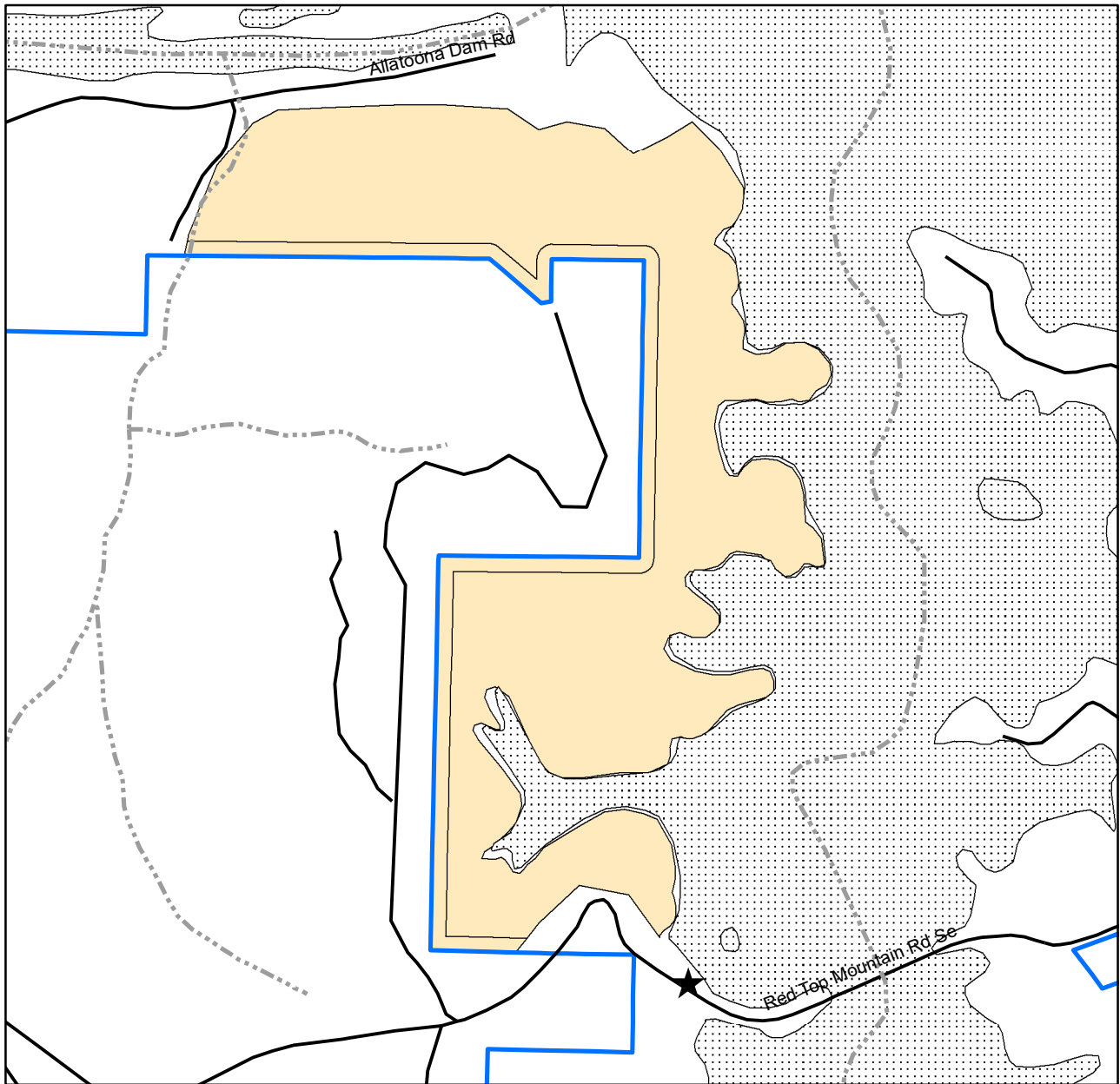

Legend

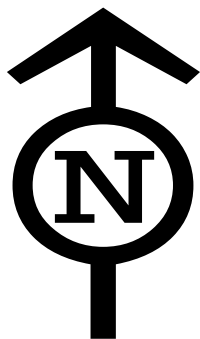

- ★ Hunting Access/Parking
- - - - Creeks
- Major Roads
- Boundary Line
- ⋯ Lake Surface
- Hunting Area



Deer Hunting
Archery Only
December 1 to
December 31

**US Army Corps
of Engineers**
MOBILE DISTRICT

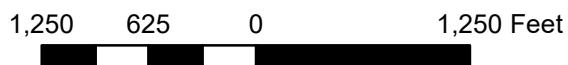

US Army Corps of Engineers
Operations Project Management Office
678-721-6700

Webster's Overlook Hunting Area

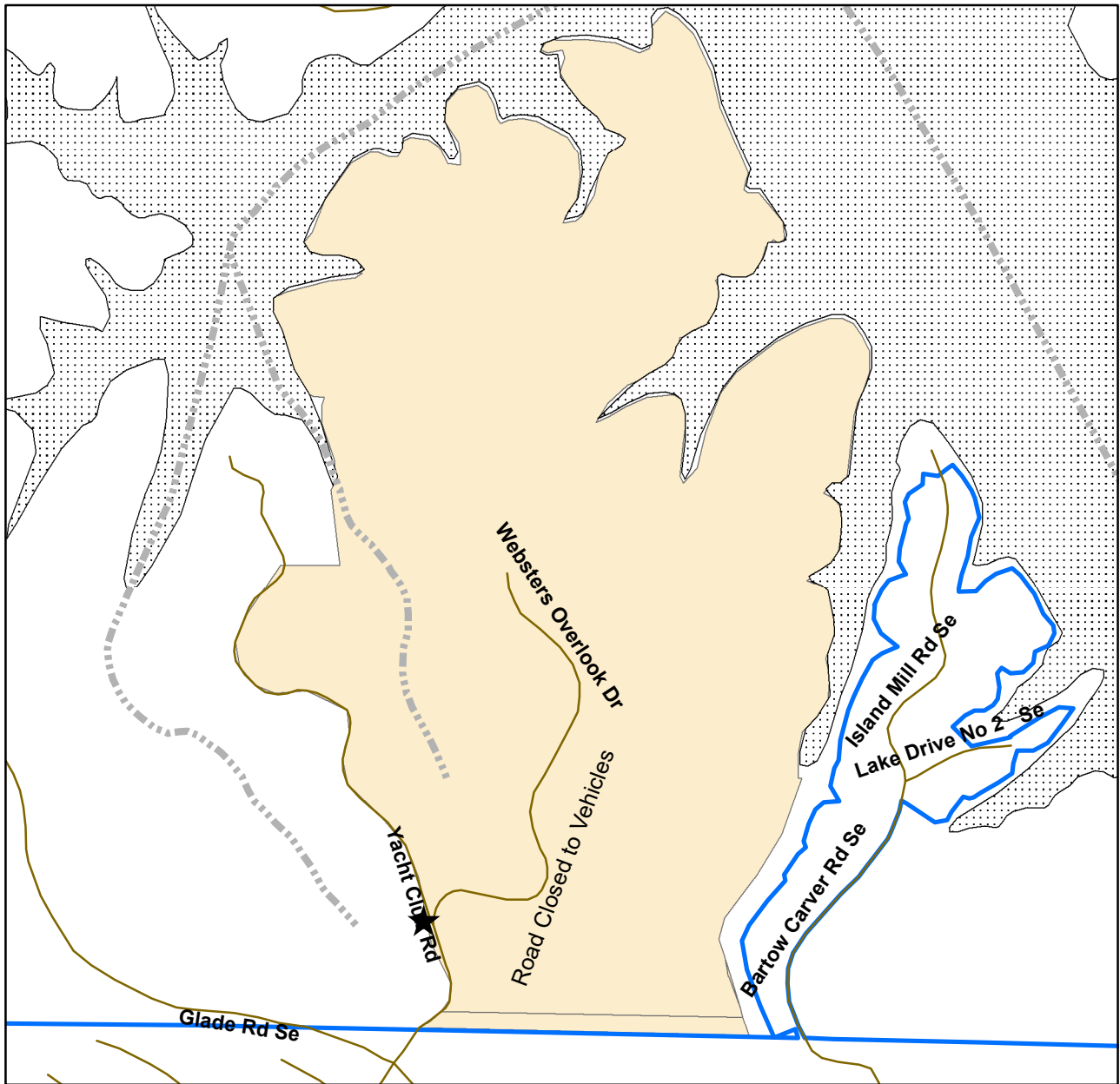

Legend

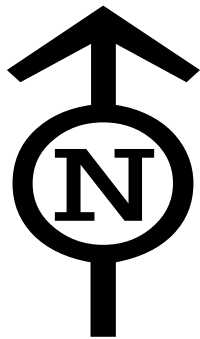

- ★ Hunting Access/Parking
- Creeks
- Major Roads
- Boundary Line
- ▒ Lake Surface
- Hunting Area



**US Army Corps
of Engineers**
MOBILE DISTRICT

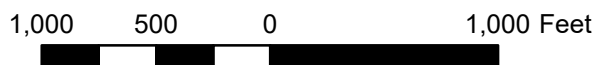

US Army Corps of Engineers
Operations Project Management Office
678-721-6700